

Part number	R09701NOBCH1		
Number of resistor elements	Single-unit		
Mounting direction	Vertical		
Bushing fixing method	Screw		
Shaft type	Optional		
Shaft length	Optional		
Center detent	<input type="checkbox"/> None <input type="checkbox"/> 1CC <input type="checkbox"/> 7CC <input type="checkbox"/> 41CC		
Total resistance	500Ω~1000KΩ		
Resistance taper	Optional		
Operating temperature range	-10℃~+70℃		
Electrical characteristics	Total resistance tolerance	<input type="checkbox"/> ±20% <input type="checkbox"/> Other	
	Rated power	0.05W	
	Max. operating voltage	50V AC, 20V DC	
	Residual resistance	20Ω max	
	Sliding noise	less than 150mV	
	Insulation resistance	100MΩmin, 250V DC	
Mechanical characteristics	Total rotational angle	300°±5°	
	Rotational torque	2~25mN.m	
	Stopper strength	0.5N.m	
	Push-pull strength	80N max	
	Vibration	10 to 55 to 10Hz/min., amplitude is 1.5mm for all the frequencies, in X, Y and Z directions and for 2 hours respectively	
Durability	Operating life	15, 000 cycles	
MOQ	1000PCS		

### Dimensions

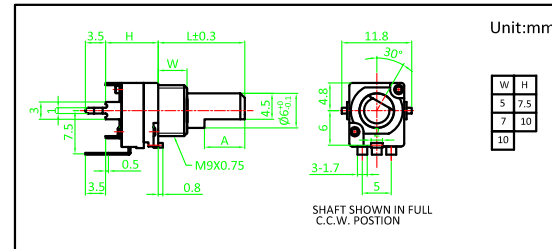

### Mounting Hole Dimensions

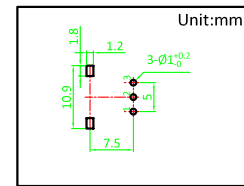

### Circuit Diagram

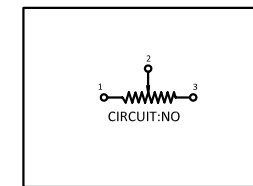

### Control Panel Dimensions

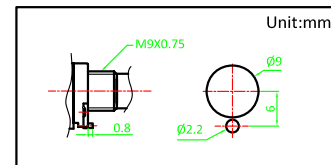

### Screw Dimensions

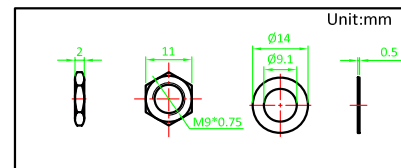

### Shaft Options

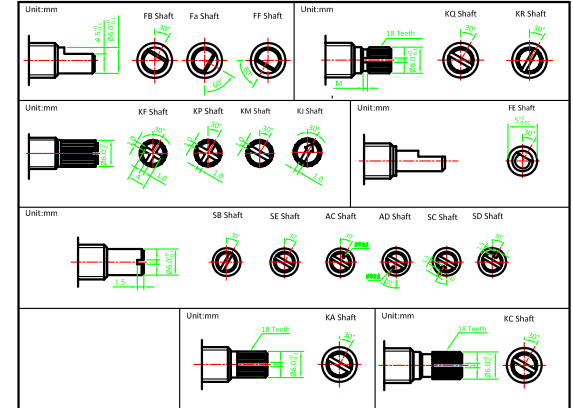

### Shaft Length Options

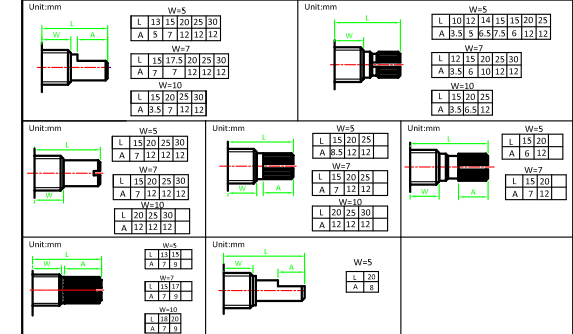

### Resistance Taper Options

A Taper	B Taper	C Taper	MIN
05 A	1 B	05 C	M
10 A	2 B	10 C	N
15 A	3 B	15 C	
20 A	4 B	20 C	
25 A		25 C	
30 A		30 C	